

AREBOS

Shopping trolley

AR-HE-ET03CG/AR-HE-ET03CS



Follow all the safety precautions in this instruction manual to ensure safe use.

Thank you for your trust in AREBOS.

Table of contents

1. Safety precautions	3
1.1 Explanation of the symbols	3
1.2 Security Warnings.....	3
2. Scope of Delivery	4
3. Assembly.....	4
4. Technical Data.....	5
5. Environmentally friendly disposal	6
3.1 Disposal and packaging	6
3.2 Disposal of old equipment.....	6
Imprint.....	7

Thank you for purchasing our product. Please read the instruction manual carefully before using the product for the first time. If you give the product to a third party, this instruction manual must be handed over with it. Keep the instruction manual for future reference. The drawings in this guide may not match the physical objects. Please refer to the physical objects.

1. Safety precautions

1.1 Explanation of the symbols



Warning! Read the safety instructions carefully. Failure to observe safety precautions may result in serious injury or damage. Keep the instruction manual in a safe place.



Warning! Suffocation!

1.2 Security Warnings

- Use only for the right purpose such as transporting food or other purchases. Max 40kg
- This is **not** a toy. Do not let children play with the trolley.
- Don't get on the shopping trolley, keep children away from it.
- Make sure you fully assemble the trolley.
- If any damage to the shopping trolley is noticed or you are unsure about its function, contact our customer service.

2. Scope of Delivery



Part Name	Quantity
Body + Handle	1
Canvas tote bag	1
Wheels	2
Belt	1
Bolts + Nuts	2
Allen wrench	1

3. Assembly

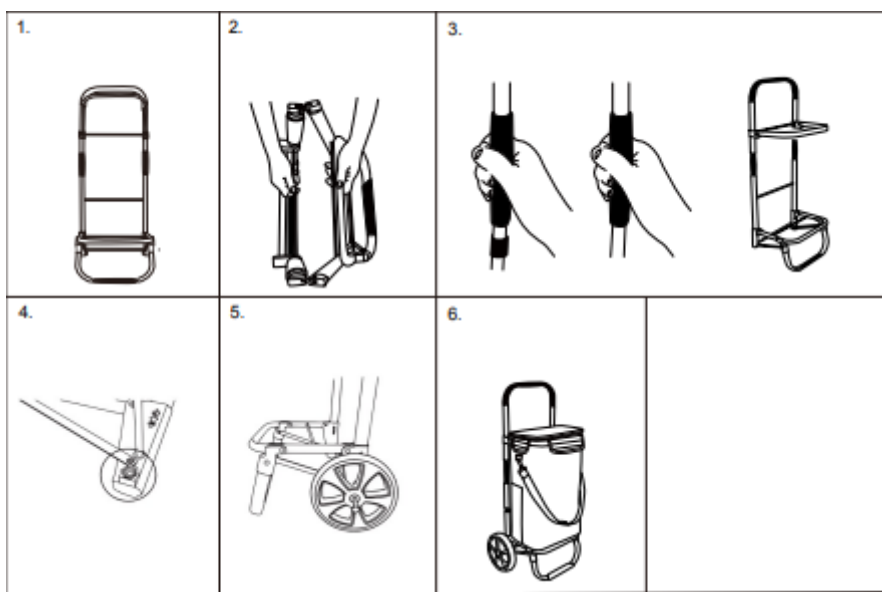

4. Technical Data

Material Pouch	Fabric
Body material	Alu
Material wheels	PVC
Dimensions unfolded	99*42*36 cm
Dimensions folded	55*42*23cm
Dimensions pouch	55*33*22cm
Wheel	21 cm
Weight	2.4 kg
Capacity	40 kg
Content	42 L
Particularities	2 side pockets, 1 cooler pocket inside the bag (25*22*7 cm), 3 reflectors

5. Environmentally friendly disposal

 **Warning! of suffocation!** Packaging material is dangerous for children. Never let children play with packaging material.

3.1 Disposal and packaging

- The packaging of your device is made of materials that are necessary to guarantee effective protection during transport. These materials are fully recyclable, thus reducing the environmental impact. Dispose of the packaging in a bin for recyclable materials.

3.2 Disposal of old equipment

- Waste equipment must be disposed of in accordance with the guidelines and regulations of local waste disposal. Contact your local administration for the address of the nearest recycling center and drop off your device there.

Our customer service number: Tel. +49 (0) 931 9080 3000

Fax: +49 (0) 931 4523 2799 / E-Mail: info@arebos.de

Office address: Canbolat Vertriebs GmbH • Gneisenastraße 10-11 • 97074 Würzburg

The return address can be found in the imprint: <https://www.arebos.de/impressum/>

Imprint

Product Name: AREBOS Shopping Trolley
Model Number: AR-HE-ET03CG AR-HE-ET03CS
Item number: 4252023117302 4252023117319

If this product is modified without our consent, it will lose all warranty.

Date/Signature Manufacturer/Location:

Würzburg 12.10.2023



Signature
Dipl.-Inform. (Univ.) Korhan Canbolat, Managing Director

Representative of this Instruction Manual/Technical Data:
Dipl.-Inform. (Univ.) Korhan Canbolat, Managing Director

Office Address:
Canbolat Vertriebs GmbH
Gneisenaustraße 10-11
97074 Würzburg

The return address can be found in the imprint: <https://www.arebos.de/impressum/>

VAT identification number: DE 263752326
The court of entry in the commercial register is Würzburg, HRB 10082
WEEE Reg. No. DE 61617071