

# AREBOS

## Scooter with LED wheel

AR-HE-LRG / AR-HE-LRB / AR-HE-LRH



Please follow all security measures in this user's manual to ensure a secure use.

Thank you for trusting in AREBOS.

# Table of Contents

<b>1. Safety Instructions.....</b>	<b>3</b>
1.1 Explanation of the symbols.....	3
1.2 Safety Warnings .....	3
<b>2. Assembly.....</b>	<b>4</b>
<b>3. Recommendations for using .....</b>	<b>6</b>
<b>4. Advice for using.....</b>	<b>7</b>
<b>5. Environmentally friendly disposal.....</b>	<b>7</b>
5.1 Disposal and packaging.....	7
5.2 Disposal of old equipment .....	7
<b>EU Declaration of Conformity.....</b>	<b>8</b>

Thank you for purchasing our product. Please read the operating instructions carefully before using the product for the first time. If you give the product to a third party, this instruction manual must also be handed over. Keep this manual for future reference.

The drawings in this manual may not correspond to the physical objects. Please refer to the physical objects.

# 1. Safety Instructions

## 1.1 Explanation of the symbols



**Warning!** Hot surface!



**Warning!** Danger of crushing hands!



**Warning!** Read the safety instructions carefully. Failure to follow the safety precautions could result in serious injury or damage. Keep the operating instructions in a safe place.



**Warning!** When using this product, wear personal protective equipment (safety helmet and clothing).

## 1.2 Safety Warnings

- Use this product only with shoes, clothing, safety helmet and - clothing.
- Keep in mind the brake becomes hot when used!
- Make sure all parts (screws) are tightened.
- This product is for motion. Do not attempt any tricks or stunts!

## 2. Assembly

Your scooter arrives almost fully assembled. For use, open the quick release.



Open the rapid tightening lever and press the folding button to unfold the Scooter.

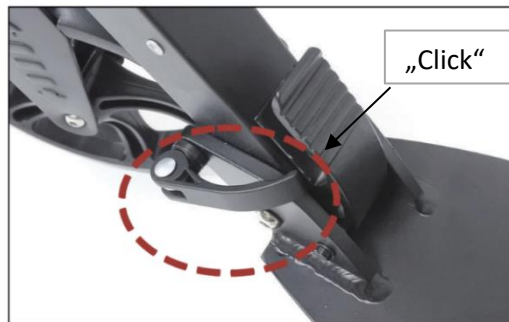

Make sure to fully unfold until you hear the “snap in”. Close the quick release. Make sure it’s tight.



Unlock the rapid tightening lever and open the upper clamp to adjust the height until hear a “Click”.



By opening the quick release, you can adjust the steering to a comfortable height. Make sure the knob snaps into a hole in the steering column. After adjustment, close the quick release.



Insert the handle into the T-piece until you hear a "click". Pull the brake handle to check the braking effect.



Turn the screws on the bottom to tighten or loosen the brake.



Use the smallest tool to adjust these 2 screws to make the folding tight/loose.

### 3. Recommendations for using

- Before using, check your scooter is correctly assembled. There must be a “click” at each moment of engagement in the vertical locking position of the steering column. (see “2. Assembly”)
- Check the screws to be tightened.



1. Handle brake
2. Quick release for handle
3. Steering column
4. Quick release lever for steering column
5. Spring for damping
6. Locking lever for folding mechanism
7. Folding mechanism
8. Stand
9. Foot brake
10. Disc brake

## 4. Advice for using

- This product is not a toy, it's sport and fun article for motion (only).
- To brake, use for foot to press the brake.
- Take some time to learn basic of the sport to avoid accidents.
- For the safety, we advise you to use this appliance with protective equipment: helmet, elbow pads, knee pads and gloves. Always wear shoes!
- Suitable for children from 6 years.
- The maximum weight of the user is 100kg.
- The scooter can only be used by one person at a time.
- Respect the correct traffic code.
- Avoid crowded places or places with heavy traffic.
- Avoid slippery or wet surfaces.
- Avoid steep slopes and ensure that the brake is in good working condition.
- Take care of your hands in the handlebars.
- The purpose of this product is fun in motion. This scooter is not for acrobatic use. Do not jump over obstacles or attempts any other stunts.
- In all situations take care of yourself and others.
- Do not use the scooter at night.
- Do not modify or transform the scooter, especially the steering column and socket, the stem, the folding mechanism, and the brake.
- Check the condition of the bearings and wheels regularly and replace them of necessary.

## 5. Environmentally friendly disposal

### 5.1 Disposal and packaging

- The packaging of your unit consists of materials that are necessary to guarantee effective protection during transport. These materials are fully recyclable and therefore reduce the environmental impact. Dispose of the packaging in a bin for recyclable materials.  
**Danger of suffocation!** Do not leave the packaging material lying around carelessly. It could become a dangerous toy for children.

### 5.2 Disposal of old equipment

- Old appliances must be disposed of in accordance with the guidelines and regulations of the local waste disposal authority. Check with your local administration for the address of the nearest recycling centre and deliver your appliance there.

**Our customer service number: Tel. +44 (0) 208 068 5604**

**Fax: +49 (0) 931 4523 2799 / E-Mail: [info@arebos.de](mailto:info@arebos.de)**

Office adress: Canbolat Vertriebs GmbH • Gneisenaustraße 10-11 • 97074 Würzburg

You can find the **return address** in the imprint: <https://www.arebos.de/impressum/>

## EU Declaration of Conformity

We, the

Canbolat Vertriebs GmbH, Gneisenaustraße 10-11, 97074 Würzburg, Germany

hereby declare that the devices described below, by virtue of their design and construction and in the versions placed on the market by us, comply with the relevant, fundamental safety and health requirements of the EU directives.

Product name: Scooter with LED wheel

Model number: AR-HE-LRG / AR-HE-LRB / AR-HE-LRH

Item number: 4260627429325 / 4260627429318 / 4260627429301

If the device is modified without our consent, this declaration of conformity loses its validity.

Tested according to EU standard:

EN-14619:2019

Date/Signature Manufacturer/Place:

Würzburg, January 5, 2022



Signature:

Dipl.-Inform. (Univ.) Korhan Canbolat, Managing Director

Representative of these instructions for use/technical data:

Dipl.-Inform. (Univ.) Korhan Canbolat, Managing Director

**Office address:**

Canbolat Vertriebs GmbH

Gneisenaustraße 10-11

D-97074 Würzburg

Return address can be found in the imprint: <https://www.arebos.de/impressum/>

VAT identification number: DE 263752326

Court of the Commercial Register is Würzburg, HRB 10082

WEEE Reg.-No. DE 61617071