

AREBOS

Hand-held Mixer Stirrer

Ar-HE-MX-1600

User's Manual



CE

Please follow all security measures in this user's manual to ensure a secure use.

Contents

1. Safety Instructions	3
1.1 Explanation of the symbols	3
1.2 General safety instructions for power tools	3
1.2.1 Work area safety	3
1.2.2 Electrical safety	4
1.2.3 Personal safety	4
1.2.4 Use and care instructions for power tools	4
1.2.5 Service	5
1.3 Special safety instructions	5
1.3.1 Safety instructions for mixing machines for building materials.	6
1.3.2 Additional safety instructions for mixing machines for building materials.	6
1.3.3 Noise and dust emission	6
2. Description of the Machine	7
3. Product Description.....	7
3.1 Intended use	7
3.2 Improper use	7
3.3 Residual risk	8
4. Use	8
4.1 Check before commissioning	8
4.2 Operating instructions	8
4.3 Start-up and use	8
4.4 Attaching the mixing paddle	8
4.5 Switching ON/OFF	9
4.6 Operation	9
4.7 Removing the mixing paddle	9
4.8 Storage	9
5. Cleaning and Maintenance	10
6. Technical Specifications.....	11
7. Disposal Instruction.....	12
7.1 Disposal of the packaging	12
7.2 Disposal of waste equipment	12
7.3 Meaning of the "dustbin"	12

Please read and save these instructions. Read through this user's manual carefully before using product. Protect yourself and others by observing all safety information, warnings and cautions. Failure to comply with instructions could result in personal injury and/or damage to product or property. Please retain instructions for future reference.

1. Safety Instructions

1.1 Explanation of the symbols



Read this manual thoroughly before using the mixer.



Wear ear protectors when using the mixer.



Wear safety goggles when using the mixer.



Wear a dust mask when using the mixer.



Double insulation (Class II). Do not require a ground prong.



Attention - Read the operating instructions!

1.2 General safety instructions for power tools

- Read all safety precautions and instructions. Failure to follow the safety precautions and instructions may result in an electric shock, fire and/ or serious injury.
- **Save all these safety precautions and instructions for future reference.**
- The term „power tool“ in the safety instructions refers to your mains-operated (corded) power tools or battery-operated (cordless) power tools.

1.2.1 Work area safety

- Keep your work area clean and well lit. Cluttered or dark areas invite accidents.
- Do not operate power tools in explosive environments, such as in the presence of flammable liquids, gases or dust. Power tools create sparks which may ignite the dust or fumes.
- Keep children and bystanders away while operating a power tool. Distractions can cause you to lose control of the machine.

1.2.2 Electrical safety

- The mains plug of the power tool must match the electrical outlet. Never modify the plug in any way. Do not use any adapter plugs with earthed (grounded) power tools. Unmodified plugs and matching electrical outlets will reduce the risk of electric shock.
- Avoid body contact with earthed (grounded) surfaces, such as pipes, heaters, cookers and refrigerators. There is an increased risk of electric shock if your body is earthed (grounded).
- Do not expose power tools to rain or wet conditions. There is an increased risk of electric shock if water penetrates your power tool.
- Do not abuse the cord. Never use the cord for carrying, pulling or unplugging the power tool. Keep cord away from heat, oil, sharp edges or moving parts. Damaged or entangled cords increase the risk of electric shock.
- When operating a power tool outdoors, only use extension cables which are suitable for outdoor use. This will reduce the risk of electric shock.
- If it is unavoidable that you operate the power tool in a damp location, use a residual current device (RCD). The use of a residual current device reduces the risk of electric shock.

1.2.3 Personal safety

- Stay alert, watch what you are doing and apply your common sense when operating a power tool. Do not use a power tool while you are tired or under the influence of drugs, alcohol or medication. A moment of inattention while operating power tools may result in serious personal injury.
- Use personal protective equipment. Always wear eye protection. Protective equipment such as dust mask, non-slip safety shoes, protective helmet, or hearing protection used for appropriate conditions will reduce the risk of personal injury.
- Prevent unintentional starting. Ensure the switch is in the “off” position before connecting to the power supply and/or battery pack, picking up or carrying the tool. Carrying a power tool with your finger resting on the switch or energizing a power tool with the tool being switched on can lead to accidents.
- Remove any adjusting key or wrench before switching on the power tool. A wrench or a key left attached to a rotating part of the power tool may result in personal injury.
- Do not overreach. Keep proper footing and balance at all times. This enables better control of the power tool in unexpected situations.
- Dress properly. Do not wear loose clothing or jewellery. Keep your hair, clothing and gloves away from moving parts. Loose clothes, jewellery or long hair can be caught in moving parts.
- If external dust extraction/collection devices are attached, make sure that they are connected and used properly. The use of dust extraction/collection devices can reduce dust-related hazards.

1.2.4 Use and care instructions for power tools

- Do not force the power tool. Use the correct power tool for your task. The correct power tool will do the job better and more safely at the rate for which it was designed.
- Do not use the power tool if the switch is defective. Any power tool that cannot be controlled with the switch is dangerous and must be repaired.
- Disconnect the plug from the power source and/or remove the battery pack before making any adjustments, changing accessories, or storing the power tool. Such precautionary measure prevents the power tool from being switched on accidentally.
- Store idle power tools out of the reach of children and do not allow persons who are unfamiliar with the power tool or these instructions to operate the power tool. Power tools are dangerous in the hands of untrained users.
- Maintain power tools with care. Check for misalignment or binding of moving parts, breakage

of parts and any other condition that may affect the power tool's operation. If damaged, have the power tool repaired before use. Many accidents are caused by poorly maintained power tools.

- Keep cutting elements sharp and clean. Properly maintained cutting elements with sharp cutting edges are less likely to bind and are easier to control.
- Use the power tool, accessories and insertion tools, etc. in accordance with these instructions, taking into account the working conditions and the work to be performed. Using the power tool for applications which are different from those intended ones can lead to dangerous situations.

1.2.5 Service

- Have your power tool serviced by a qualified repair person using only original replacement parts. This will ensure that the safety of the power tool is well maintained.

1.3 Special safety instructions

- **Caution:** In order to avoid accidents and to prevent the risk of fire or electric shock, and to minimize the risk of injury as well, please observe the following safety instructions. Read these instructions carefully.
 1. Keep your work area clean. Cluttered areas always invite accidents.
 2. Do not expose the machine to rain. Never use it in a wet or damp environment. Also keep the machine away from flammable liquids.
 3. Do not use the machine in the vicinity of children. Children and physically - or mentally impaired persons should be supervised to ensure that they are kept at a safe distance from the machine. Make sure that, under no circumstance should children get access to the device or the power supply.
 4. Keep the machine safely and out of reach of children.
 5. Never carry the tool by its cord. Always keep the cable away from oil, solvents and sharp edges to prevent any possible damage.
 6. Place the machine on a stable surface. Avoid abnormal postures when operating the machine.
 7. Store the machine in a clean environment and check the power cord from time to time. If the power cord is damaged, it should only be repaired by qualified service personnel. A damaged power cord should always be replaced immediately in any case.
 8. Unplug the machine from the electrical outlet before removing the mixing paddle. Always verify that the machine is switched off before plugging it into the outlet.
 9. Working with this mixer requires high concentration and unimpaired attention. Always check whether the machine runs normally. Never operate the machine when you are tired.
 10. Check for signs of damage before each use of the mixer. Verify the working condition of the machine to ensure an unimpaired operation. Check all parts of the machine and make sure that they are all firmly connected. If any damage is found, it should only be eliminated by qualified service personnel. Have the ON/OFF switch replaced if any problems in connection with this component are found, unless otherwise the manual gives other more instructions explicitly.
 11. Use only original spare parts.
 12. Make sure that the mixing paddle is attached to the output pivot securely. A firm connection between the output pivot and the mixing paddle prevents accidents.
 13. When using the machine, hold it firmly with both hands. Under no circumstances should the machine be operated with only one hand!
 14. Wear safety goggles to avoid eye injury caused by splashing liquid.
 15. Only use a flawless and undamaged machine.
 16. Never put down the machine while the mixing paddle is still rotating.

17. Hold the machine straight during operation and do not pull it from the mixing container immediately after the machine is switched off, otherwise your clothing could get dirty by the splashing liquid.

1.3.1 Safety instructions for mixing machines for building materials.

- Wear hearing protection when using a mixing machine for building materials. Exposure to noise can cause hearing loss.
- Hold the machine by the insulated gripping surfaces when performing the operation, as the machine may come into contact with hidden power lines or its own cord. The contact with a "live" wire can cause metal parts to become "live" and thus result in an electrical shock.
- When using a mixing machine for building materials, always equip it with a residual current device (RCD) whose rated tripping current is no more than 10 mA, in order to avoid a hazard.

1.3.2 Additional safety instructions for mixing machines for building materials.

- Keep water away from any parts of the machine, otherwise it may cause an electric shock to the people in the work area.
- Before performing any adjustment, service or maintenance work, disconnect the power cord of the machine from the electrical outlet. The electrical performance of your extension cable must be at least as strong as that of the machine. Check that the mains voltage corresponds with the value indicated on the nameplate of the machine.

1.3.3 Noise and dust emission

- An extremely high noise level can cause hearing damage. Therefore, suitable hearing protection should be worn — Especially when using the machine in enclosed rooms.
- Splinters can cause eye injuries. Therefore, always wear safety goggles or glasses with safety glass.
- Always wear a helmet and safety shoes.
- Always wear proper, tight-fitting clothing.
- Always tie long hair together and remove the loose jewelry.

2. Description of the Machine

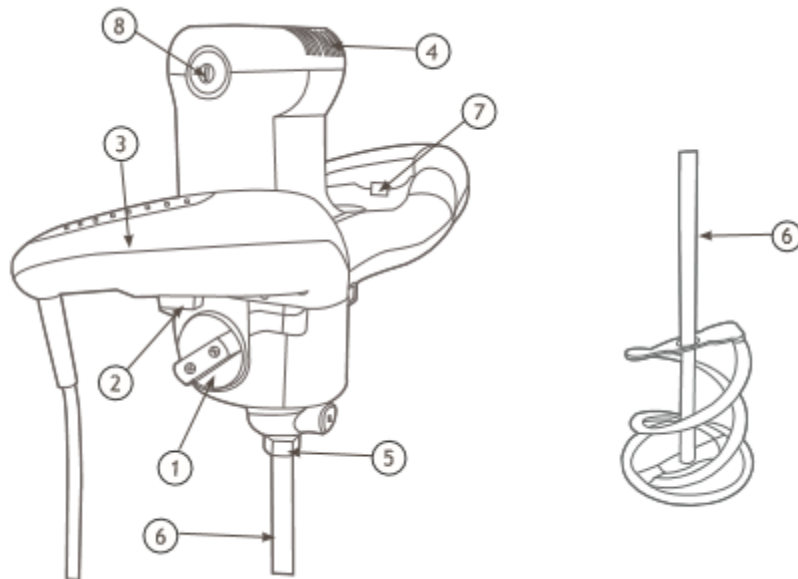

1. Gear selection switch
2. ON/OFF switch
3. Lock button for ON/OFF switch
4. Air slots
5. Pivot with M14 female thread
6. Mixing paddle
7. Adjusting dial
8. Brush holder

3. Product Description

3.1 Intended use

- The product is specially designed for mixing paint, lime water and concrete. Make sure that the mixing paddle is attached to the output pivot securely. A firm connection between the output pivot and the mixing paddle prevents accidents. When using the tool, hold it firmly with both hands. Under no circumstances should the tool be operated with only one hand. Never put down the tool while the mixing paddle is still rotating.

3.2 Improper use

- Any application with this product not listed in the "Intended use" is deemed to be a case of misuse. This product must not be used for the following purposes:
 - To use the tool as a drill.
 - To polish, grind, sharpen or engrave with special adapters.
 - As a drive for other devices.
- Risk of injury! Use of other or non-original components with the machine will void the warranty.

3.3 Residual risk

- Even when the product is used properly, certain residual risks cannot be ruled out.
- Potential risks may be derived from the specific type and construction of the machine as follows:
 - Contact with the rotating chuck (crush injury)
 - Reaching into the rotating mixing paddle (cutting injury)
 - Hearing impairment, if no hearing protection is used.
 - Electric shock when touching to the non-insulated electrical components.
- If the instructions stated in this manual are not observed, other residual risks may arise due to improper use.

4. Use

4.1 Check before commissioning

- Inspections to be performed before commissioning.
 - Before each work session or after every 4 hours of operation at most, the following inspections must be carried out prior to the commissioning of the machine. Detailed guidelines can be found in the section of "MAINTENANCE". If any fault is detected, the HMRW cannot be used until it has been repaired.
1. Check the hand-held mixer thoroughly for signs of damage. Make sure that all parts are present and firmly fixed. Pay special attention to the mixing paddle and check whether it is properly attached to the output pivot.
 2. If the mains cord of this machine is damaged, it must be replaced with a special connecting cable which is available from the manufacturer or its service centre.

4.2 Operating instructions

- Before operating or servicing this hand-held mixer, YOU SHOULD READ and UNDERSTAND the manual thoroughly.

4.3 Start-up and use

- Improper use of the machine may cause damage to the unit. Therefore, please observe the following instructions:
 - Use only tools with a diameter as specified before.
 - Load the tool properly in such a way that the speed does not drop sharply or that the machine would not come to a standstill.
 - Verify that the information indicated on the nameplate corresponds with the actual voltage of the power supply. This machine is designed for a mains voltage of 230 V.

4.4 Attaching the mixing paddle

- Screw the mixing paddle with its M14×2 end as far as possible into the output pivot of the machine and tighten securely with a wrench (22 mm).

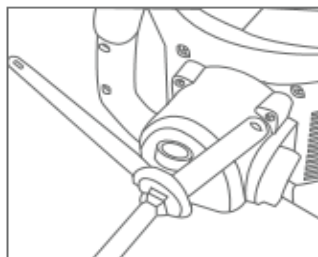

4.5 Switching ON/OFF

- Always hold the machine with both hands during operation. Press and hold the ON/OFF switch (2) to initiate the mixing process. With the switch (2) in its "ON" position, press the lock button for ON/OFF switch (3). Now the switch (2) remains locked in its "ON" position. To stop the machine, press and release ON/OFF switch (2).

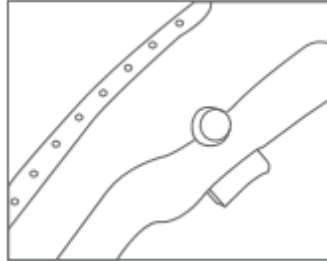

4.6 Operation

- This hand-held mixer is fitted with a two-speed transmission which allows you to select the gear as required. The first gear is slow, the second gear is faster. To select your desired gear, turn the gear selection switch (1) by 180°. In addition, with the help of the adjusting dial (7), the speed of the machine can be adjusted in either of the two gears.
- Always reduce the speed when placing the mixing paddle into the mixture, or when removing. Once the mixing paddle (6) is completely removed from the mixture, increase the speed again and allow the motor to cool down sufficiently. During the mixing process, slowly steer the machine in circular motion inside the mixing container. This should be done continuously until the whole mixture has been mixed evenly.

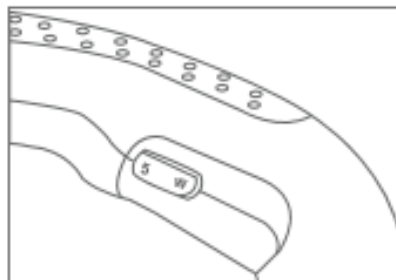

4.7 Removing the mixing paddle (STIRRER)

- Place the wrench (22 mm) onto the hexagonal piece that is located on the M 14x2 end of the mixing paddle (stirrer), then unscrew the paddle from the pivot by turning it counter-clockwise.
- When the mixing process is finished, clean the mixing paddle (6) thoroughly to avoid the accumulation of dirt and residue.
- Note: The numbers in parentheses refer to the diagram in the section of "Description of the Machine".

4.8 Storage

- The machine must be stored in a dry place, where there is no risk of exposure to extreme temperatures.

5. Cleaning and Maintenance

- Unplug the machine from the electrical outlet before performing any maintenance or repair work. Thoroughly clean the machine. Dirt, oil stains and other materials adhered to the unit should be removed regularly.

The connection between the output pivot and the mixing paddle should be checked regularly. Make sure that the screws are tightened securely. The panel should be free from any defects or damage. Regularly check that the power cord is intact.

The insulating layer must not have any fractures. After about 100 hours of operation, the carbon brush should be checked and be replaced with a new one if necessary.

- **Note:** Leave all maintenance work to a professional. The HMRW is designed for many years of trouble-free operation. However, it is very important that some simple and regular maintenance work listed in this section should be carried out. Use only original spare parts, the use of other unauthorized parts will void the warranty. Moreover, before performing the related maintenance work, make sure that the machine is disconnected from the power supply.

Routine Maintenance		Approx. every 100 hours	Approx. every 200 hours
Motor brushes	Check	√	
	Change when necessary		
Transmission grease	Check/replace		√

- This hand-held mixer is equipped with self-deactivating carbon brushes. The machine will switch off automatically when the brushes are worn down to a certain level. Refer to the instructions for replacement as shown below.

Replacing the carbon brushes of the motor

1. Loosen the two brush holders (8) on the sides of the motor housing using a screwdriver.
 2. Remove the worn-out brushes and replace them with new ones.
 3. Tighten the brush holders (8), ensuring that the brushes are fixed securely. Also, keep the air slots (4) free of dirt and residue so that the machine can cool down sufficiently.
- **Note:** The numbers in parentheses refer to the diagram in the section of „Description of the Machine“.

6. Technical Specifications

Model no.	HMRW01	HMRW02	HMRW03	HMRW04	HMRW05
Rated voltage	230 V	230 V	230 V	230 V	230 V
Frequency	50 Hz	50 Hz	50 Hz	50 Hz	50 Hz
Total weight of machine (kg)	5,8	6,0	5,7	6,0	6,0
Total weight of machine without paddle (kg)	4,6	4,6	4,6	4,6	4,6
Height of machine (mm)	875	875	875	875	875
Power (W)	1200	1600	875	875	875
Idle speed in 1 st gear	180-380 min-1				
Idle Speed in 2 nd gear	300-650 min-1				
Tool size	M 14				
Max. diameter of mixing paddle (mm)	100	160	90	120	140
Sound pressure level (dBA)	94				
Sound power level (dBA)	105				
Suitable for stirring	Plaster/cement/mortar/tile adhesive/ flush-mounting material				
Typical Hand-Arm-Vibration	ah=4,09 m/s ² , K=1,5 m/s ² ah with the description of the procedure „mixture of lime water“				

Measured values determined according to EN 60 745-2-1 and EN 60745-1.

Warning:

- The vibration emission value during the actual use of the machine can differ from the one stated in this instruction manual or the one indicated by the manufacturer. This can be caused by the following factors which you should pay attention to before or during use:
 - Is the machine used properly?
 - Is the type of the material that is to be processed correct?
 - Is the machine in good working order?
 - If necessary, attach an optional anti-vibration handle and make sure that the handle is fixed securely to the machine.
- If you feel uncomfortable or notice skin discoloration on your hands during the use of the machine, stop working immediately. Take sufficient work breaks. Failure to have sufficient work breaks may result in the hand-arm vibration syndrome. There should be an estimation of the extent of exposure in relation to the type of work or the use of the machine and also appropriate work breaks should be arranged. In this way, the extent of exposure can be considerably reduced over the entire work time. Minimize the risk caused by the exposure to vibration. Maintain this machine according to the instructions stated in this manual. If the machine is frequently used, please contact your dealer and get some anti-vibration accessories (e.g. handles). Avoid the use of this machine at a temperature of 10 °C or lower. Create a work schedule in order to minimize your exposure to vibration. A certain amount of noise generated by this machine cannot be avoided. Therefore, you should only carry out the noise-intensive work during specific periods of time. Maintain quiet periods and limit the duration of your work to the minimum as necessary. To ensure the personal safety for you and for the bystanders as well, suitable hearing protection should be worn

7. Disposal Instruction

7.1 Disposal of the packaging

- Please make reference to the guidelines and standards for appropriate disposal of the packaging valid in your region. In part, the package may consist of plastic bags - watch this respect, with special care to ensure that this is not out of the reach of children. There is a risk of suffocation!

7.2 Disposal of waste equipment

- Equipment must be disposed of in accordance with the rules and regulations of the local waste disposal.

7.3 Meaning of the "dustbin"



Protect our environment; electrical appliances do not belong in household waste. Use the provided for the disposal of electrical equipment collection points and enter your electrical and electronic equipment that you no longer use. They help ensure that the potential effects of incorrect disposal on the environment and human health to be avoided. So, do your part to recycle, recycling and other forms of recovery of waste electrical and electronic equipment. Information on where the devices are disposed of, please contact your local authorities or local Governments.

Our customer service number: +49 (0) 931-45232700

EU Declaration of Conformity

We,

Canbolat Vertriebs GmbH, Gneisenaustraße 10-11, 97074 Würzburg, Germany,

Hereby declare that the product named below, seen its design and construction as well as according to our sales, has been complied with the relevant and basic health and safety EU-requirements.

Name of the product: AREBOS Hand-held Mixer Stirrer

Model Nr.: AR-HE-MX-1600

Art. Nr.: 4260551580000

If the product has any modification not allowed by us, this declaration loses its validity.

Guidelines/regulations:

Machinery Directive: 2006/42/EC

EC Directive of Electromagnetic Compatibility (EMC) 2014/30/EU

Restriction on Hazardous Substances in Electrical and Electronic Equipment (RoHS) test in accordance with Directive 2002/95/EC and 2011/65/E

Standards:

EN 55014-1:2006/+A1:2009/+A2:2011

EN 60745-2-1:2010

EN 55014-2:1997/+A1:2001/+A2:2008

EN ISO 12100:2010

EN 61000-3-2:2014

EK9-BE-87:2014

EN 61000-3-3:2013

EK9-BE-88:2014

EN 60745-1:2009+A11:2010

Date/Manufacturer Signature/Location:

Würzburg, 26.11.2018



Identification of the signatory:

Korhan Canbolat, head of the company

Authorised representative for the technical documentation:

Korhan Canbolat

Office address:

Canbolat Vertriebs GmbH

Gneisenaustraße 10-11

D-97074 Würzburg

Return address can be found in the imprint: <https://www.arebos.de/impressum/>

VAT identification number: DE 263752326

Court of the Commercial Register is Würzburg, HRB 10082

WEEE Reg.-No. DE 61617071