

AREBOS

Electric Blanket



Please follow all security measures in this user's manual to ensure a secure use.



Thank you for trusting in AREBOS.

Table of Contents

1 Introduction and safety instructions.....	3
1.1 Introduction.....	3
1.2 Explanation of the symbols	3
1.3 Safety instructions.....	5
1.4 Intended use.....	7
2 Scope of delivery / Unit parts	8
3 Operating instructions.....	9
4 Using the blanket	10
4.1 Application method	10
4.2 Fault introductions.....	10
4.3 After use.....	10
5 Cleaning and maintenance	11
6 Storage	12
7 Technical Data	12
8 Environmentally friendly disposal.....	13
8.1 Disposal and packaging	13
8.2 Disposal of old equipment.....	13
EU Declaration of Conformity	14

Thank you for purchasing our product. Please read the operating instructions carefully before using the product for the first time. If you give the product to a third party, this manual must be handed over with it. Keep the instruction manual for future reference. The drawings in this manual may not match the physical objects. Please refer to the physical objects.

1 Introduction and safety instructions

1.1 Introduction

- This instruction handbook is intended to familiarise you with the installation, use and maintenance of the product. To install the unit safely and correctly, please read the operating instructions **before** you start.

1.2 Explanation of the symbols



Warning! Read the safety instructions carefully. Failure to follow the safety precautions could result in serious injury or damage. Keep the operating instructions in a safe place.



Note! Pull out the mains plug.



Warning! Risk of electrical voltage!



Use with caution when using this article!

⚠ WARNING! This signal symbol/word indicates a hazard with a medium level of risk which, if not avoided, may result in death or serious injury. injury if not avoided.

⚠ CAUTION! This signal symbol/word indicates a hazard with a low level of risk which, which, if not avoided, may result in a minor or moderate injury. injury if not avoided.

Note! This signal symbol/word warns you of possible property damage.



Read the instructions for use



Do not insert pins



Do not use folded or rucked



Not to be used by very young children (0-3) years



Do not bleach



Do not tumble dry



Do not iron



Do not dry clean



Maximum washing temperature 40°C, mild process



This product **must not** be disposed of with household waste!





By means of a CE marking, it can be recognized that a product complies with the legal requirements of European legal standards and therefore may be traded within the European Community.



This product has been tested and certified by TÜV Süd. The symbol "GS" stands for tested safety. Products marked with this symbol comply with the requirements of the German Product Safety Act (ProdSG).

1.3 Safety instructions

- Your safety is of the most importance to us. Please make sure that you read this instruction booklet **before** attempting to install and use the appliance. If you are unsure of any of the information contained in this booklet, please contact the Retailer where you purchased your unit.
-  **WARNING!** Read all safety and usage instructions. Failure to follow the safety information and instructions can cause electric shock, fire and/or serious injury. Keep all safety and usage instructions for future reference.
- **DO NOT** use the product until you read the instruction manual.
- Make sure you have read the instruction manual thoroughly and understand the contents before you start the installation.
- The instructions are in the interest of your safety.
-  **WARNING! Danger of suffocation!** Packaging material is dangerous for children. Never let children play with packaging material.

WARNING! Risk of electric shock!

Faulty electrical installation or excessive mains voltage can lead to electric shock.

- Only connect the electric blanket if the mains voltage of the socket of the socket corresponds to the specification on the type plate of the control unit.
- Only connect the electric blanket to an easily accessible socket so that you can quickly disconnect the electric blanket from the mains in the event of a malfunction.
- Do not operate the electric blanket if it has visible damage or if the cables or plugs are defective.
- If a cable of the control unit is damaged, the control unit must be replaced with an original spare part.
- Do not open the housing of the control unit, but leave the repair to specialists in order to avoid hazards. Contact a specialist workshop for this purpose. Liability and warranty claims are excluded in the event of repairs carried out independently, improper connection or incorrect operation.
- Only parts that correspond to the original appliance data may be used for repairs. This electric blanket contains electrical and mechanical parts that are essential for protection against sources of danger.
- The electric blanket must not be operated with an external timer or a separate remote control system.
- Never pull the mains plug out of the socket by the mains cable, always grasp the mains plug.
- Keep the electric blanket, plugs and cables away from open flames and hot surfaces.
- Do not bend the cables or place them over sharp edges.
- Make sure that children do not stick objects into the electric blanket.
- When you are not using the electric blanket, cleaning it or if a malfunction occurs, always switch off the electric blanket and disconnect the mains plug from the socket.

WARNING! Danger to children and persons with reduced physical, sensory or mental capabilities (for example, partially disabled persons, elderly persons with reduced physical and mental capabilities) or lack of experience and knowledge (for example, older children).

- - This electric blanket can be used by children aged eight years and above and persons with reduced physical, sensory or mental capabilities or lack of experience and knowledge if they have been given supervision or instruction concerning use of the electric blanket in a safe way and understand the hazards involved. Children must not play with the electric blanket. Cleaning and user maintenance must not be carried out by children unless they are eight years

or older and are supervised.

- - Keep children younger than eight years away from the electric blanket and the control panel with its cables.
- - Children younger than three years must not use this electric blanket as they are incapable of reacting to overheating.
- - The electric blanket must not be used by persons who are insensitive to heat and by other vulnerable persons who are unable to react to overheating.
- - Do not leave the electric blanket unattended during operation.
- - Do not let children play with the packaging foil. They can get caught in it while playing and suffocate.

 **CAUTION! Risk of injury!**

There is a risk of injury from cables lying around.

- Lay the cables so that they do not become a tripping hazard. Also avoid using an extension cable. Especially after waking up, there is an increased risk of tripping due to cables lying around.

 **CAUTION! Risk of damage to health!**

Prolonged use at the highest level may cause skin irritation or discomfort.

- Always use the electric blanket briefly at the beginning and not at the highest level. Check your skin before increasing the power and the duration of use.
- Stop using the electric blanket immediately if you find the heat from the electric blanket uncomfortable or painful.
- Make sure that you do not fall asleep during use. If you become very tired during use, select setting 1 for safety.

NOTE! Risk of damage!

Improper handling of the electric blanket can result in damage to the blanket.

- Do not switch on the electric blanket when it is folded or pushed together.
- Do not pull the electric blanket into a bed cover and do not put the electric blanket around the mattress.
- Do not pinch or bend the electric blanket.
- Do not switch on the electric blanket when it is still damp, e.g. after cleaning.
- Do not place any large or heavy objects, such as suitcases, woollen blankets and bags, on the electric blanket during operation.
- Do not place any heat sources, such as hot water bottle, heating pad or similar, on the electric blanket during operation.
- Before each use on an adjustable bed or in the case of split mattresses, make sure that the electric blanket or the power cord are not pinched or pushed together.
- Before each use, check that the electric blanket, control panel and power cord do not show any signs of wear or damage. If such signs are present or if the electric blanket has been used improperly, you must have it checked by a specialist workshop before using it again. In this case, contact the service address indicated on the warranty card.
- Do not insert needles or other sharp objects into the electric blanket. the electric blanket.
- Store the electric blanket in a dry place.
- The electric blanket must not be used wet.

To reduce the risk of personal injury or damage to property, basic important safety instructions must be observed including the following:

- Read the instruction manual thoroughly and retain for future reference. Ensure before use you

know how the electric blanket works and how to operate it.

- Always turn the power off at the power outlet before you insert or remove a plug. Remove by grasping the plug - do not pull on the cord.
- Turn the power off and remove the plug when the electric blanket is not in use or before cleaning.
- Always use the electric blanket from a power outlet of the voltage (A.C. only) marked on the rating label.
- Use only the type of controller marked on the rating label.
- Used as under blanket or over blanket.
- Do not use if it is damp or wet.
- This blanket is not intended for medical use in hospitals.
- Do not use together with another heating appliance.
- When in use ensure the blanket and mains leads do not get trapped.
- This appliance can be used by children aged from 8 years and above and persons with reduced physical, sensory or mental capabilities or lack of experience and knowledge if they have been given supervision or instruction concerning use of the appliance in a safe way and understand the hazards involved. Children shall not play with the appliance. Cleaning and user maintenance shall not be made by children without supervision.
- Children should be supervised to ensure that they do not play with the appliance.
- Examine the blanket frequently to check that there are no signs of wear or damage. If any damage/wear is spotted, do not use the blanket and seek specialist advice.
- If the supply cord of this appliance is damaged, it must only be replaced by the manufacturer, its service agent or similarly qualified persons in order to avoid a hazard.
- The appliance must be returned to the manufacturer or his agent if the link has ruptured.
- The appliance is not to be used by young children over the age of three unless the controls have been pre-set by a parent or guardian, or unless the child has been adequately instructed on how to operate the controls safely.
- The appliance must not to be used by persons insensitive to heat and other very vulnerable persons who are unable to react to overheating.
- Children under the age of three are not to use this appliance due to their inability to react to overheating.
- The switch or control unit must not be allowed to get wet during washing and that during drying the cord must be positioned to ensure that water does not flow into the switch or control.
- The appliance is not to be used for warming animals.

1.4 Intended use

- The electric blanket is designed exclusively for use in private households as described in these instructions. The electric blanket may only be used as a cover, not as a base.
- It is intended exclusively for private use in dry indoor rooms and is not suitable for commercial use in hospitals, surgeries, etc.
- The electric blanket is not a medical device and is not suitable for therapeutic purposes.
- Only use the electric blanket as described in these operating instructions. Any other use is considered improper and may result in property damage or even personal injury. The electric blanket is not a child's toy.
- The manufacturer or dealer accepts no liability for damage caused by improper or incorrect use.

2 Scope of delivery / Unit parts

Check electric blanket and scope of delivery

NOTE! Risk of damage!

If you open the packaging carelessly with a sharp knife or other pointed objects, the electric blanket can be damaged quickly.

- Be very careful when opening the packaging.

- Take the electric blanket out of the packaging and check whether the electric blanket or the individual parts show any damage. If this is the case, do not use the electric blanket.
- Contact our customer service (see below for contact details).
- Check that the delivery is complete.
- Peel off any protective foil.
- Remove the packaging material.



No.	Designation
1	Electric Blanket
2	Connection cable
3	Control panel

Control panel with Display

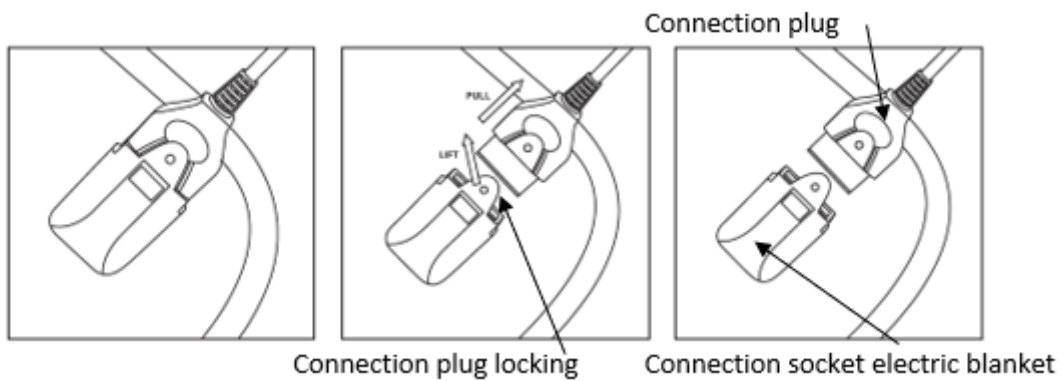
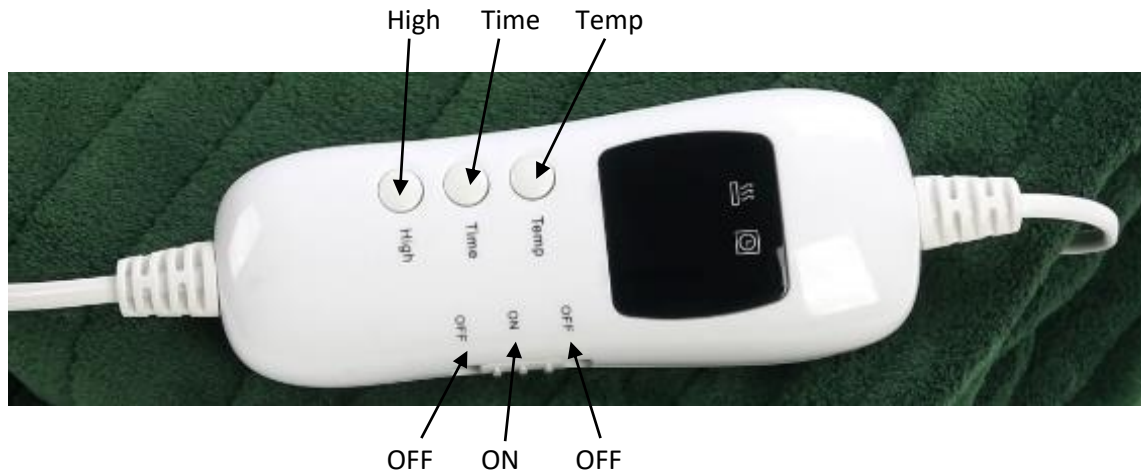

3 Operating instructions

- This blanket is intended to be used as a “THROW” or “OVER BLANKET” and therefore should always be placed on top of an individual, not under them, or on the top of a bed sheet. It is not to be used as an “under blanket”.
- Connect the controller to the blanket (The blanket has a socket attached that the controller slots into) and ensure it is fully connected.
- Ensure there is a mains supply is nearby and that when in use, the mains lead will not be in a position that could cause people to trip over it. When plugged into the mains supply, the controller must be within easy reach of the user.

4 Using the blanket

- Please set at “H” preheating 30-60 minutes before using. When using it, select the appropriate tap position according to human body’s feeling. If you will go to sleep or use it for a long time, please set at “L” tap position or “1” tap position.

4.1 Application method

- The starting up state is the standby state. The digital display of temperature is 0 and the timing display is 0.
 - Press TEMP and display temperature at 7 tap position and the timing state is 9 hours.
 - Press TEMP and display the tap position circulates among L1.2.3.4.5.6.7.
 - Press TIME and the timing state circulates from 1-9 hours
 - Press High key and the temperature tap position are preheating which is displayed as H. This tap position will automatically change to L tap position 1 hour later.

4.2 Fault introductions

- If the temperature is displayed as P, please check whether the coupler of the electric blanket has been connected firmly or not and restart it. If the fault cannot be removed, it means the internal connection of the electric blanket has problems and it needs to ask help from after-sales service.
- If the temperature is displayed as E, it means the electric blanket has internal short circuit and has been broken.
- If the temperature on the controller displays as C which means the controller has been overheated, please disconnect the appliance from the mains, and wait till the controller cools down then it is safe to use.
- To remove the controller, lift the locking tab up with your finger and pull the plug directly out. Do not pull the controller cable and Do Not try and pull the controller plug out without lifting the locking tab as you will damage the socket.

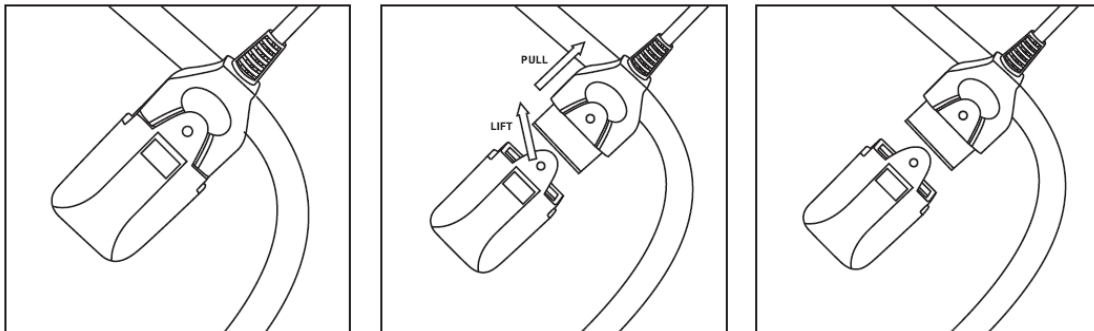

4.3 After use

When the blanket is not in use, please switch the controller to the off position; remove the plug from the power socket. If the blanket is not to be used for a long period of time, store the blanket in a cool and dry place.

5 Cleaning and maintenance

WARNING! Risk of electric shock!

Moisture can cause electric shock.

- Disconnect the mains plug from the socket before cleaning the electric blanket.
- Do not immerse the electric blanket or any cable or plug in water or other liquids.
- Do not immerse the control panel in water or put it in the washing machine.

NOTE! Risk of damage!

Improper handling of the electric blanket can cause damage to the electric blanket.

- The electric blanket must not be dry-cleaned, ironed, wrung or ironed.
- When not in use and before cleaning the blanket, disconnect it from the mains.
- Disconnect the controller/s from the blanket.
- Do NOT immerse the controller/s in water or get them wet.
- Clean the surface of the cord with neutral detergent if the cord is dirty and wipe it dry with soft cloth.
- Do not submerge the controller in water or get it wet at all.
- Do not dry clean this blanket as it could damage the heating elements.
- Do not use industrial solvents such as benzene, kerosene or similar solvents to clean it.
- Machine washing of the blanket is possible; however, hand wiping it down will prolong the life of the blanket. To machine wash, remove the controller/s and place the blanket in a net bag and seal it. Use a small amount of detergent and set the washing machine to a “Delicate Wash” with a maximum temperature of 40°. When washed, remove the blanket from the net bag and drape it over a clothes line to dry. Do not use clothes pegs to secure it.
- Do NOT wring out the blanket
- Do NOT dry using a tumble dryer
- Do NOT iron the blanket
- Do NOT dry the blanket in the sun.
- Do NOT connect it to the mains supply to dry it
- Do NOT use an appliance such as a hair dryer to dry it
- Allow the blanket to dry naturally.
- Do NOT use the blanket if it is damp or wet.
- Do not try to repair the blanket if faulty – have it looked at by a qualified person.
- Examine the blanket frequently to check that there are no signs of wear or damage. If any damage/wear is spotted, do not use the blanket and seek specialist advice.
- If the mains lead or controller is damaged, do not open or attempt to repair them as they must be serviced by a qualified person.

6 Storage

- When not in use, allow it to cool down before folding, then gently fold the blanket and place back into the packing bag it arrived in.
- Make sure the blanket is dry before folding and packing it away. The blanket should be hung in a ventilated location to dry naturally.
- Do not use mothproofing agents on the blanket.
- Insulation of the blanket will be damaged if the blanket is dried under the sun, ironed or when mothproofing agents are used. Damage on the insulation material will cause safety problem.
- Do not crease the appliance by placing items on top of it during storage.
- The blanket should be store in a cool dry place.

7 Technical Data

Model	AR-HE-HD*
AR-HE-HDBE180 - 4252023105385 / AR-HE-HDBO180 - 4252023105392 / AR-HE-HDG200 - 4252023105460 / AR-HE-HDBR200 - 4252023105453 / AR-HE-HDBO200 - 4252023105446 / AR-HE-HDBE200 - 4252023105439 / AR-HE-HDA200 - 4252023105422 / AR-HE-HDG180 - 4252023105415 / AR-HE-HDBR180 - 4252023105408 / AR-HE-HDA180 - 4252023105378 / AR-HE-HDG160 - 4252023105361 / AR-HE-HDBR160 - 4252023105354 / AR-HE-HDBO160 - 4252023105347 / AR-HE-HDBE160 - 4252023105330 / AR-HE-HDA160 – 4252023105323	
Mains voltage	220-240 V ~ 50 Hz
Protection class	II <input type="checkbox"/>
Power	120 W
Dimensions (3 Variants)	160 x 120 cm / 180 x 130 cm / 200 x 180 cm

We reserve the right to make technical and optical changes to the article in the course of product improvements.

8 Environmentally friendly disposal

 **WARNING! Danger of suffocation!** Packaging material is dangerous for children. Never let children play with packaging material.

8.1 Disposal and packaging

- The packaging of your unit consists of materials that are necessary to guarantee effective protection during transport. These materials are fully recyclable and therefore reduce the environmental impact. Dispose of the packaging in a bin for recyclable materials.

8.2 Disposal of old equipment

- Old appliances must be disposed of in accordance with the guidelines and regulations of the local waste disposal authority. Check with your local administration for the address of the nearest recycling centre and deliver your appliance there.



The symbol of the crossed-out dustbin on a Waste electrical or electronic equipment indicates that it must not be disposed of with household waste at the end of its life. Collection points for waste electrical and electronic equipment are available free of charge in your area. You can obtain the addresses from your city or local government. You can find out about other return options created by us on our website www.arebos.de.



The separate collection of Waste electrical or electronic equipment is intended to enable the reuse, recycling or other forms of recovery of Waste electrical or electronic equipment and to avoid the negative consequences of disposal on the environment and human health.

Our customer service number: Tel. +44 (0) 208 068 5604

Fax: +49 (0) 931 4523 2799 / E-Mail: info@arebos.de

Office address: Canbolat Vertriebs GmbH • Gneisenaustraße 10-11 • 97074 Würzburg

Return address can be found in the imprint: <https://www.arebos.de/impressum/>

Sales tax identification number: DE 263752326

Registration court in the commercial register is Würzburg, HRB 10082

WEEE-Reg. No. DE 61617071

EU Declaration of Conformity



We, the **Canbolat Vertriebsgesellschaft mbH**
Gneisenaustraße 10-11
97074 Würzburg
Germany

declare in sole responsibility that the following product:

Brand **AREBOS**

Product Name Electric Blanket

Product Model AR-HE-HD*

Article Number AR-HE-HDBE180 - 4252023105385 / AR-HE-HDBO180 - 4252023105392 / AR-HE-HDG200 - 4252023105460 / AR-HE-HDBR200 - 4252023105453 / AR-HE-HDBO200 - 4252023105446 / AR-HE-HDBE200 - 4252023105439 / AR-HE-HDA200 - 4252023105422 / AR-HE-HDG180 - 4252023105415 / AR-HE-HDBR180 - 4252023105408 / AR-HE-HDA180 - 4252023105378 / AR-HE-HDG160 - 4252023105361 / AR-HE-HDBR160 - 4252023105354 / AR-HE-HDBO160 - 4252023105347 / AR-HE-HDBE160 - 4252023105330 / AR-HE-HDA160 - 4252023105323

has been developed, constructed and manufactured in compliance with the requirements of the **European Directives:** 2014/30/EU
2014/35/EU
2011/65/EU / 2015/863/EU

The object of the declaration described above is in conformity with the relevant European Union harmonization legislation.

The assessment is based on the following applied **harmonized standards:** EN 60335-2-17:2013/A1:2020
EN 60335-1:2012/A15:2021
EN 62233:2008
EN 55014-1:2017/A11:2020
EN 55014-2:2015
EN 61000-3-2:2019
EN 61000-3-3:2013/A1:2019

Other technical standards and specifications applied: Regulation (EC) No 1907/2006

Place and date of issue: Würzburg, 14.07.2022

Signature:

Dipl.-Inform. (Univ.) Korhan Canbolat, Managing Director

If the device is modified without our consent, this declaration of conformity loses its validity.