

AREBOS

Hand truck

AR-HE TSK150S/AR-HE TSK150A

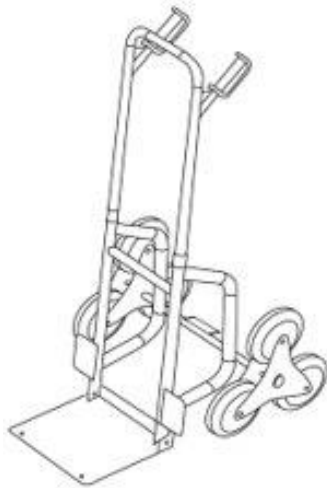

Follow all the safety precautions in this instruction manual to ensure safe use.

Thank you for your trust in AREBOS.

Table of contents

.....	1
1. Safety.....	2
Symbol explanation.....	2
Warnings.....	2
2. Scope of delivery.....	3
3. Parts.....	3
4. Specifications.....	4
5. Assembly.....	4
6. Commissioning.....	4
7. Cleaning and maintenance.....	4
Disposal instructions.....	5
Disposal and packaging.....	5
Imprint.....	5

1. Safety

Symbol explanation



Warning! Read the safety regulations carefully. That Failure to comply with safety precautions may result in serious injury or damage. Keep the instruction manual in a safe place.







Warning! Risk of crushing hands!

Warnings

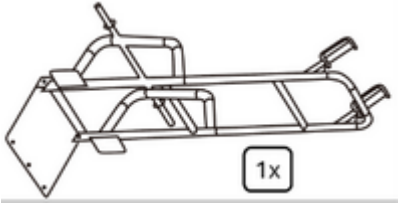
1. Please note the max. load capacity of 150kg and 40kg when climbing stairs.
2. The hand truck is intended exclusively for the transport of goods.
3. Place the load so that the load is evenly distributed.
4. The manufacturer is not liable for injuries and property damage resulting from improper assembly or use.

2. Scope of delivery

 1x	 2x	 2x	 2x
Hand truck (1)	Wheels (2)	Washer (2)	Security material (2)

3. Parts

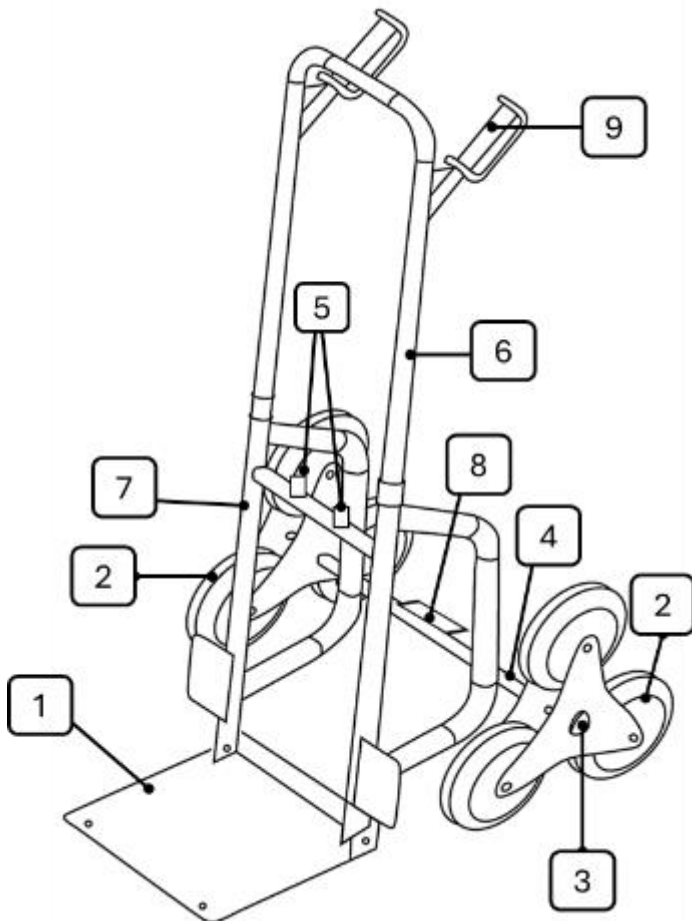

1 loading shovel	2 wheels	3 security material
4 axle	5 knobs	6 upper metal frame
7 lower metal frame	8 step pedal	9 handle

4. Specifications

Unfolded dimensions	1090 x 460 x 598 mm
Folded dimensions	740 x 460 x 365 mm
capacity	150 kg
Max. load capacity when climbing stairs	40 kg
Weight	11.7 kg

5. Assembly

1. Fold the loading shovel down at a 90° angle.
2. Attach the wheels to the axle using the supplied safety material.
3. Press the two red buttons. Then insert the handle bracket into the tube.

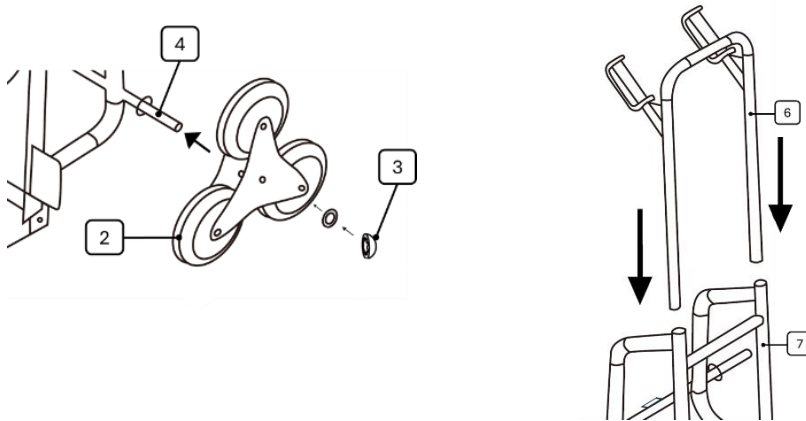

6. Commissioning

- To ensure safe use, check the connection of all parts.
- Fold down the loading shovel. By pressing the push buttons, you can vary the height adjustment of the handlebar.
- The load capacity is max. 150 kg with even weight distribution. When used on steps, the maximum load capacity is reduced to 40 kg. Please note that the corresponding max. load capacity must not be exceeded!

7. Cleaning and maintenance

- After use, clean with a dry cloth and store in a dry place.

Disposal instructions

Disposal and packaging

- Please ensure that the packaging is disposed of appropriately in accordance with the guidelines and standards applicable in your region. Some of the packaging may consist of plastic bags - take special care to ensure that they do not get into the hands of children. There is a risk of suffocation!

Our customer service number: +49 (0) 931-45232700

Canbolat Vertriebs GmbH • Gneisenaustraße 10-11 • 97074 Würzburg

Imprint

Product Name: Hand Truck

Item number: 4252023124553 4252023124560

Model Number: AR-HE-TSK150S AR-HE-TSK150A

If this product is modified without our consent, it will lose all warranty.

Date/Signature Manufacturer/Location: Würzburg, 27.03.2024



Signature:

Dipl.-Inform. (Univ.) Korhan Canbolat, Managing Director

Representative of this Instruction Manual/ Technical Data:

Dipl.-Inform. (Univ.) Korhan Canbolat, Managing Director

Office Address:

Canbolat Vertriebs GmbH

Gneisenaustraße 10 – 11

97074 Würzburg

The return address can be found in the imprint: <https://www.arebos.de/impressum/>

VAT identification number: DE 263752326

The court of entry in the commercial register is Würzburg, HRB 10082

WEEE Reg. No. DE 61617071