

AREBOS

Office chair

AR-HE-BS1



Please follow all safety measures in this user manual to ensure safe use.

Thank you for your trust in AREBOS.

Table of contents

1	Introductory and safety instructions.....	3
1.1	Introduction.....	3
1.2	Explanation of the symbols	3
1.3	Important safety instructions	3
2	Scope of delivery	4
3	specifications.....	4
4	Assembly	5
5	Seat height adjustment	6
5.1.	Increase seat height	6
5.2.	Reduce seat height.....	6
6	Setting the tilt angle	6
7	Storage, cleaning	6
8	Environmentally friendly disposal.....	6
7.1	Disposal and packaging	6
	EU Declaration of Conformity	7

Thank you for purchasing our product. Please read the user manual carefully before using the product for the first time. If you leave the product to a third party, this operating manual must be handed over with it. Keep the instruction manual for future reference. The drawings in this manual may not match the physical objects. Please refer to the physical objects.

1 Introductory and safety instructions

1.1 Introduction

- This manual is intended to familiarize you with the installation, use, and maintenance of the product. To install the device safely and correctly, please read the user manual before you begin.

1.2 Explanation of the symbols



Warning! Read the safety instructions carefully. Failure to follow safety precautions may result in serious injury or damage. Keep the instruction manual in a safe place.



Beware of the risk of crushing!



Attention, no toys! Do not let children sit unsupervised in the chair.



Do not stand, lie or tilt!

1.3 Important safety instructions

- Your safety is of the utmost importance to us. Please make sure you have read this instruction manual **before** attempting to use the item. If you are unsure about the information contained in this guide, please contact the retailer where you purchased your device.
-  **WARNING! Suffocation!** Packaging material is dangerous for children. Never let children play with packaging materials.
- This is not a toy. Do not let toddlers play with it / jump on it.
- Do not use the item until you have completely assembled the chair.

- Do not use sharp objects such as knives or the like when opening the package.
- Keep all items away from children during assembly.
- **⚠ WARNING! Injury!** Some parts can be sharp-edged or heavy.
- Use the chair only for the purposes originally intended by the manufacturer.
- Use the chair only on a flat surface.
- The **maximum load capacity is 136kg (1 person)**, do not exceed the weight to avoid injury or breakage. Do not lean your whole body on the armrests.
- Do not place the chair next to fireplaces, as the materials are highly flammable.
- Do not expose the office chair to direct sun, as this can cause damage.
- Make sure that all screws are tightened.
- The gas spring may only be replaced or repaired by trained specialists.
- The item is not intended for commercial use. The item is designed for private indoor use only.
- If any modifications are made to the item, the warranty will be void. In this case, the manufacturer bears no liability for damage

2 Scope of delivery

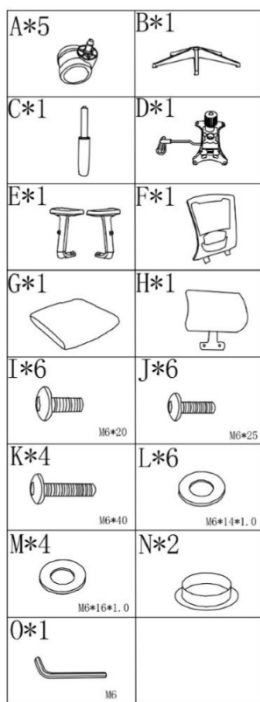

Part	Designation
A	Wheels
B	Base
C	Gas spring
D	Lifting mechanism
E	Armrest right and left
F	Backrest
G	Seat
H	Headrest
I, J, K, L, M, N	Screws, washers
O	Hex key

3 specifications

Model	AR-HE-BS1
Color	Black
Ultimate load	136kg
Seat	46-56cm
Seat size	51*50cm
Overall depth	112-126cm
Weight	12kg

4 Assembly

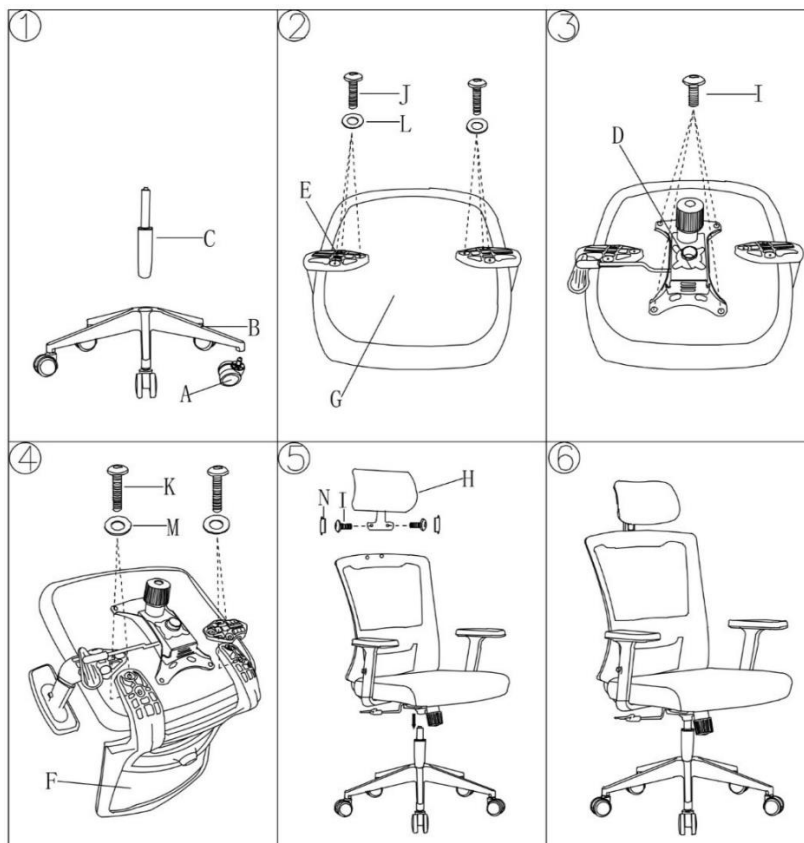

Step 1: Assemble the base

- Insert the rollers (A) into the openings provided in the base (B) until a clicking sound is heard.
- Place the gas spring (C) in the central opening on the base

Step 2: Assemble the armrests

- Turn the seat (G) upside down.
- Install the armrests (E) on the right and left sides of the seat (G)
- Secure these with screws (J) and washers (L)

Step 3: Assemble the lifting mechanism

- Place the lifting mechanism (D) on the bottom of the seat (G)
- Use screws (I) to fasten and tighten them with the hex wrench (O)

Step 4: Connect the backrest to the seat

- Fix the backrest (F) to the mounted seat with the screws (K) and washers (M)

Step 5: Connect the seat to the base

- Place the assembled seat and lifting mechanism on top of the gas spring (C) and base (B)
- Make sure the parts are pressed firmly into each other

Step 6: Install the headrest

- Attach the headrest (H) to the backrest (F) with screws (N) and washers (I).
- Tighten all the screws tightly, make sure the chair is stable.

5 Seat height adjustment

5.1. Increase seat height

Stand next to the chair and pull the height adjustment lever up with one hand without straining the seat.

5.2. Reduce seat height

Sit on the item and push the height adjustment lever down with one hand.

6 Setting the tilt angle

- Pull the lever under the seat to adjust the tilt angle using your body weight (tilt backwards and forwards)
- Press the lever under the seat to fix the tilt angle

7 Storage, cleaning

Always store the item in a dry and clean place at room temperature when not in use. Clean only with water and then wipe dry with a cleaning cloth.
Important! Never clean with harsh detergents.

8 Environmentally friendly disposal

 **WARNING! Suffocation!** Packaging material is dangerous for children. Never let children play with packaging material.

7.1 Disposal and packaging

- The packaging of your device is made of materials necessary to guarantee effective protection during transport. These materials are fully recyclable and thus reduce the environmental impact. Dispose of the packaging in a bin for recyclable materials.

Our customer service number: Tel. +49 (0) 931 9080 3000

Fax: +49 (0) 931 4523 2799 / E-Mail: info@arebos.de

Office address: Canbolat Vertriebs GmbH • Gneisenastraße 10-11 • 97074 Würzburg

Return address can be found in the imprint: <https://www.arebos.de/impressum/>

Sales tax identification number: DE 263752326

Registration court in the commercial register is Würzburg, HRB 10082, WEEE-Reg. No. DE 61617071

EU Declaration of Conformity

We, the **Canbolat Vertriebsgesellschaft mbH**
Gneisenaustraße 10-11
97074 Würzburg
Germany

declare in sole responsibility that the following product:

Brand **AREBOS**

Product Office chair

Article 4252023126922

was developed, constructed EN16955:2017
and manufactured in accordance EN1335-1:2020+A1:2022
with EN1335-2:20182017
with the requirements of the
European Directives:

The subject matter of the declaration described above corresponds to the respective European Union harmonisation legislation.

Place and date of issue: Würzburg, 12.02.2025

Signature:



Dipl.-Inform. (Univ.) Korhan Canbolat, Managing Director

If the device is modified without our consent, this declaration of conformity loses its validity.